



**Sycamore Road**  
Chester Le Street DH2 3QQ  
**£135,000**





This footer paragraph is an example only and should not be relied upon as complying with current legislation. These particulars, whilst believed to be accurate are set out as a general outline only for guidance and do not constitute any part of an offer or contract. Intending purchasers should not rely on them as statements of representation of fact, but must satisfy themselves by inspection or otherwise as to their accuracy. No person in this firms employment has the authority to make or give any representation or warranty in respect of the property.

# Sycamore Road

Chester Le Street DH2 3QQ



x 1



x 1



x 1

Nestled in a tranquil cul-de-sac on Sycamore Road, Kimblesworth, this charming one-bedroom semi-detached bungalow presents an excellent opportunity for those seeking a peaceful retreat. The property boasts UPVC double glazed windows, ensuring warmth and energy efficiency, complemented by gas central heating provided by a modern combination boiler.

Upon entering, you are welcomed into an entrance hall that leads to a comfortable lounge, perfect for relaxation or entertaining guests. The kitchen is functional and offers ample space for culinary pursuits. The well-proportioned bedroom provides a serene space for rest, while the shower room, equipped with a WC, adds to the convenience of this delightful home.

Although the bungalow requires some refurbishment, it offers immediate vacant possession, allowing you to make it your own without delay. This property is ideal for retired people, downsizers, or investors looking to add value through renovation.

Do not miss the chance to view this lovely bungalow. Early viewing is highly recommended, so please call

0191 3729898 to arrange your appointment. Embrace the potential of this property and make it your own in the heart of Kimblesworth.

Freehold  
Council tax band A  
EPC rating C

## ENTRANCE HALL

## LOUNGE

12'7" x 11'10" (3.84m x 3.61m)

## KITCHEN

10'10" x 10'6" (3.30m x 3.20m)

## BEDROOM

12'5" x 10'5" (3.78m x 3.18m)

## SHOWER ROOM/WC

## OUTSIDE

[www.venturepropertiesuk.com](http://www.venturepropertiesuk.com)

## GROUND FLOOR

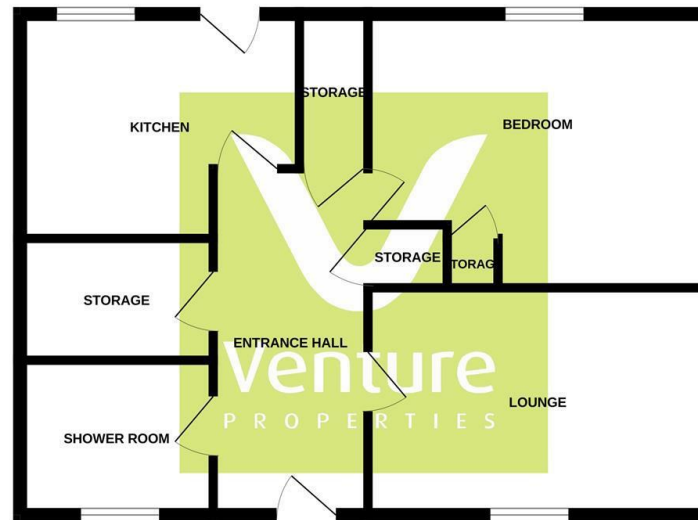

Whilst every attempt has been made to ensure the accuracy of the floorplan contained here, measurements of doors, windows, rooms and any other items are approximate and no responsibility is taken for any error, omission or mis-statement. This plan is for illustrative purposes only and should be used as such by any prospective purchaser. The services, systems and appliances shown have not been tested and no guarantee as to their operability or efficiency can be given.  
Made with Metreplan ©2025



## Property Information

**0191 372 9898**

Suite 6, 15 North Burns, Chester-le-Street, County Durham, DH3 3TF  
[sales.cls@venturepropertiesuk.com](mailto:sales.cls@venturepropertiesuk.com)